

1	2	3	4	5	6	7	8	9	10	11	12	13	14
Art.-Nr. / Item No.		Farbe / Colour											
65555		schwarz / black											
65556		weiß / white											

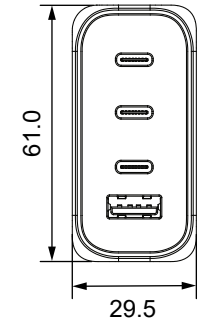
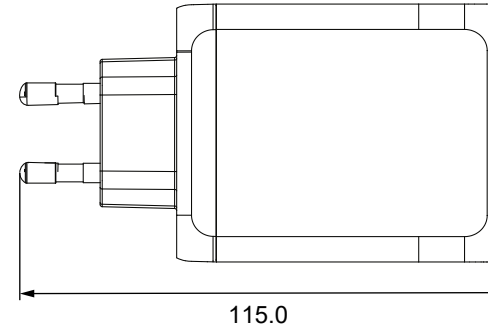
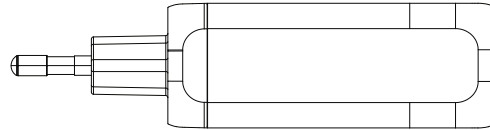

USB-C™ PD Multiport-Schnellladegerät (100 W)

- praktische Ladelösung für bis zu vier Geräte gleichzeitig
- GaN-Technologie ermöglicht schnelleres und effizienteres Laden
- kompaktere Bauweise im Vergleich zu herkömmlichen Ladegeräten

USB-C™ PD Multiport Quick Charger (100 W)

- handy charging solution for up to four devices at once
- GaN technology allows for faster, more efficient charging
- more compact design compared to conventional chargers

Änderungen

Datum	Name	gez.:	Datum	Name	Bezeichnung	Blatt
		gez.:	11.10.2023	alw	TRA USB 100W 4 Port 3xC PD/1xA QC GaN xx PL	1/2
		gepr.:	11.10.2023	anw		
		Norm:			Zeichnungs-Nr.:	von
Änderungen vorbehalten / Subject to change					65555, 65556	



	1	2	3	4	5	6	7	8	9	10	11	12	13	14
A	Technische Daten							Specifications						
B	Anschlüsse: Eurostecker (Typ C, CEE 7/16), 3x USB-C™-PD-Buchse (Power Delivery), USB-A QC-Buchse (Quick Charge)							Connections: Euro plug (Type C, CEE 7/16), 3x USB-C™ PD (Power Delivery) socket, USB-A QC (Quick Charge) socket						
C	Eingang: 100-240 V ~, 50/60 Hz, 1,5 A max.							Input: 100-240 V ~, 50/60 Hz, 1.5 A max.						
D	Ausgang PD1 / PD2: 3,3 V - 21,0 V ===, 5,0 A, 100,0 W max. 5,0 V ===, 3,0 A, 15,0 W 9,0 V ===, 3,0 A, 27,0 W 12,0 V ===, 3,0 A, 36,0 W 15,0 V ===, 3,0 A, 45,0 W 20,0 V ===, 5,0 A, 100,0 W max.							Output PD1 / PD2: 3.3 V - 21.0 V ===, 5.0 A, 100.0 W max. 5.0 V ===, 3.0 A, 15.0 W 9.0 V ===, 3.0 A, 27.0 W 12.0 V ===, 3.0 A, 36.0 W 15.0 V ===, 3.0 A, 45.0 W 20.0 V ===, 5.0 A, 100.0 W max.						
E	Ausgang PD3: 3,3 V - 11,0 V ===, 5,0 A, 55,0 W max. 5,0 V ===, 3,0 A, 15,0 W 9,0 V ===, 3,0 A, 27,0 W 12,0 V ===, 3,0 A, 36,0 W 15,0 V ===, 3,0 A, 45,0 W 20,0 V ===, 3,25 A, 65,0 W max.							Output PD3: 3.3 V - 11.0 V ===, 5.0 A, 55.0 W max. 5.0 V ===, 3.0 A, 15.0 W 9.0 V ===, 3.0 A, 27.0 W 12.0 V ===, 3.0 A, 36.0 W 15.0 V ===, 3.0 A, 45.0 W 20.0 V ===, 3.25 A, 65.0 W max.						
F	Ausgang QC: 4,5 V ===, 5,0 A, 22,5 W 5,0 V ===, 4,5 A, 22,5 W 5,0 V ===, 3,0 A, 15,0 W 9,0 V ===, 3,0 A, 27,0 W 12,0 V ===, 2,5 A, 30,0 W 20,0 V ===, 1,5 A, 30,0 W max.							Output QC: 4.5 V ===, 5.0 A, 22.5 W 5.0 V ===, 4.5 A, 22.5 W 5.0 V ===, 3.0 A, 15.0 W 9.0 V ===, 3.0 A, 27.0 W 12.0 V ===, 2.5 A, 30.0 W 20.0 V ===, 1.5 A, 30.0 W max.						
G	Ausgang PD1 + PD2 / PD3: 65,0 W + 35,0 W							Output PD1 + PD2 / PD3: 65.0 W + 35.0 W						
H	Ausgang PD1 / PD2 + QC: 65,0 W + 30,0 W							Output PD1 / PD2 + QC: 65.0 W + 30.0 W						
I	Ausgang PD2 + PD3: 65,0 W + 35,0 W							Output PD2 + PD3: 65.0 W + 35.0 W						
J	Ausgang PD3 + QC: 5,0 V ===, 3,0 A, 15,0 W max.							Output PD3 + QC: 5.0 V ===, 3.0 A, 15.0 W max.						
	Ausgang PD1 + PD2 + PD3: 45,0 W + 35,0 W + 20,0 W							Output PD1 + PD2 + PD3: 45.0 W + 35.0 W + 20.0 W						
	Ausgang PD1 + PD2 + QC: 45,0 W + 35,0 W + 18,0 W							Output PD1 + PD2 + QC: 45.0 W + 35.0 W + 18.0 W						
	Ausgang PD1 / PD2 + PD3 + QC: 65,0 W + 15,0 W							Output PD1 / PD2 + PD3 + QC: 65.0 W + 15.0 W						
	Ausgang PD1 + PD2 + PD3 + QC: 45,0 W + 35,0 W + 15,0 W							Output PD1 + PD2 + PD3 + QC: 45.0 W + 35.0 W + 15.0 W						
	Max. Ausgangsleistung: 100,0 W max.							Total output: 100.0 W max.						
	Durchschnittliche Effizienz im Betrieb: 86,7 %							Average active efficiency: 86.7 %						
	Effizienz bei geringer Last (10%): 82,4 %							Efficiency at low load (10 %): 82.4 %						
	Leistungsaufnahme bei Nulllast: 0,08 W							No-load power consumption: 0.08 W						
	Max. Betriebstemperatur: 35 °C							Max. operating temperature: 35 °C						
	Schutzklasse: II							Protection class: II						
	Gewicht: ca. 227 g							Weight: approx. 227 g						

Änderungen			Datum	Name	Bezeichnung	Blatt
Datum	Name	gez.:	11.10.2023	alw	TRA USB 100W 4 Port 3xC PD/1xA QC GaN xx PL	2/2
		gepr.:	11.10.2023	anw		
		Norm:			Zeichnungs-Nr.:	von
Änderungen vorbehalten / Subject to change					65555, 65556	

